

WIRELESS

Video Door Phone



OP-D03

WIRELESS SYSTEM FEATURES

- 2.4G digital frequency, transmission distance in free field up to 300m;
- Use AFT technique, no disturb each other;
- Telecommunication encryption to ensure safe intercom;
- Professional voice chip to ensure high quality intercom;
- High-resolution camera achieve clear image;
- 1 Gb SD card, capturing images and video function;
- Anti-demolition alarm function.
- 2 outdoor cameras and 4 indoor monitors work together on 1 channel.
- Outdoor camera is water proof with rain cover.

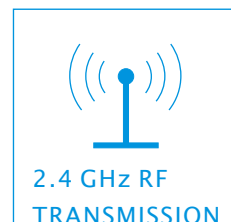

Patent product:

Independent R&D products,
Prohibit copy.

FC CE RoHS

3.5 inch
screen



INDOOR SPECIFICATION

- Screen: 3.5 inch TFT-LCD
- Sensitivity: -90dBm
- Working voltage: 250mA
- Static current: 20-30mA/3.7V
- Power adapter exchange: Input AC 100 V ~ 240 V
Output DC5V
- Battery capacity: 1350mA
- Standby time: 120hours
- Tone: 12songs
- Color: Black,White
- Dimension: 100*65*20mm
- N.W.: 150g

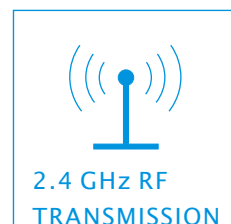

Patent product:

Independent R&D products,
Prohibit copy.

FC CE RoHS



INDOOR FUNTION

- ① Function
- ② Left
- ③ Right
- ④ Up
- ⑤ Down
- ⑥ Answer
- ⑦ Unlock

- ⑧ Monitor
- ⑨ Speaker
- ⑩ LED
- ⑪ USB
- ⑫ ON/OFF
- ⑬ SD card
- ⑭ Battery



RAINPROOF

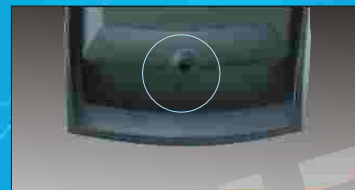

Anti-Demolition

OUTDOOR SPECIFICATION

- Working frequency: 2402~2483MHz
- Transmission power: 16-20dBm
- Camera: 1/4 inch COMS
- Power adapter : Input 100 V ~ 240 V
Output 12 V / 1 A
- Working current : 300mA
- Static current: ≤30mA
- Battery capacity: 1350mA
- Standby time: 48hours
- Color: Black
- Dimension: 175*110*60mm
- Installation: surface mounted
- N.W.: 313g

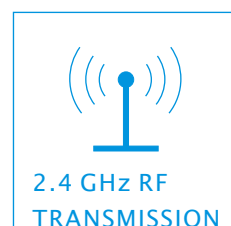

Patent product:

Independent R&D products,
Prohibit copy.

FC CE RoHS

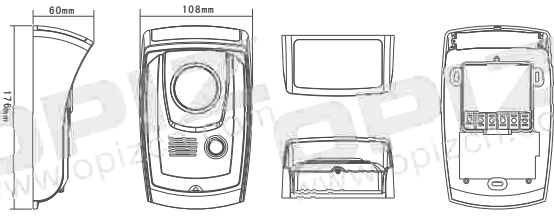

OPIZ[®]
 WWW.OPIZCN.COM



INDOOR FUNTION

- ① MIC
- ② Infrared LED
- ③ Camera
- ④ Call button
- ⑤ Speaker
- ⑥ Screws

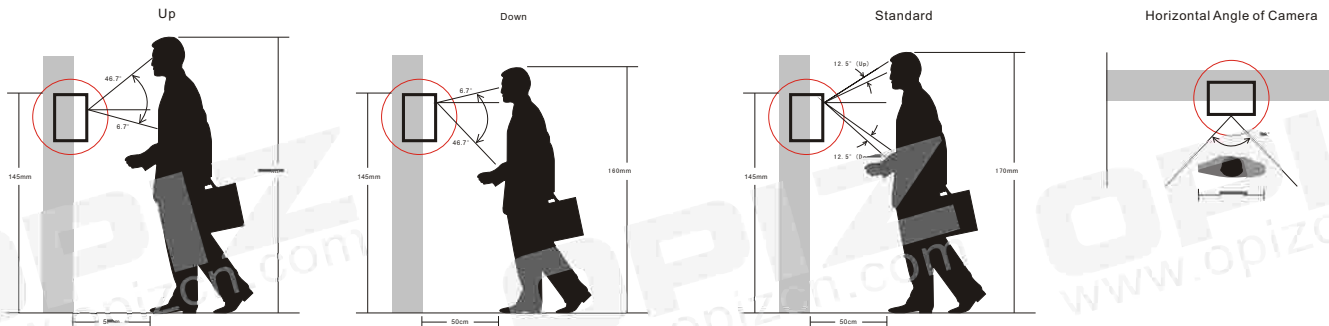

PACKAGE LIST

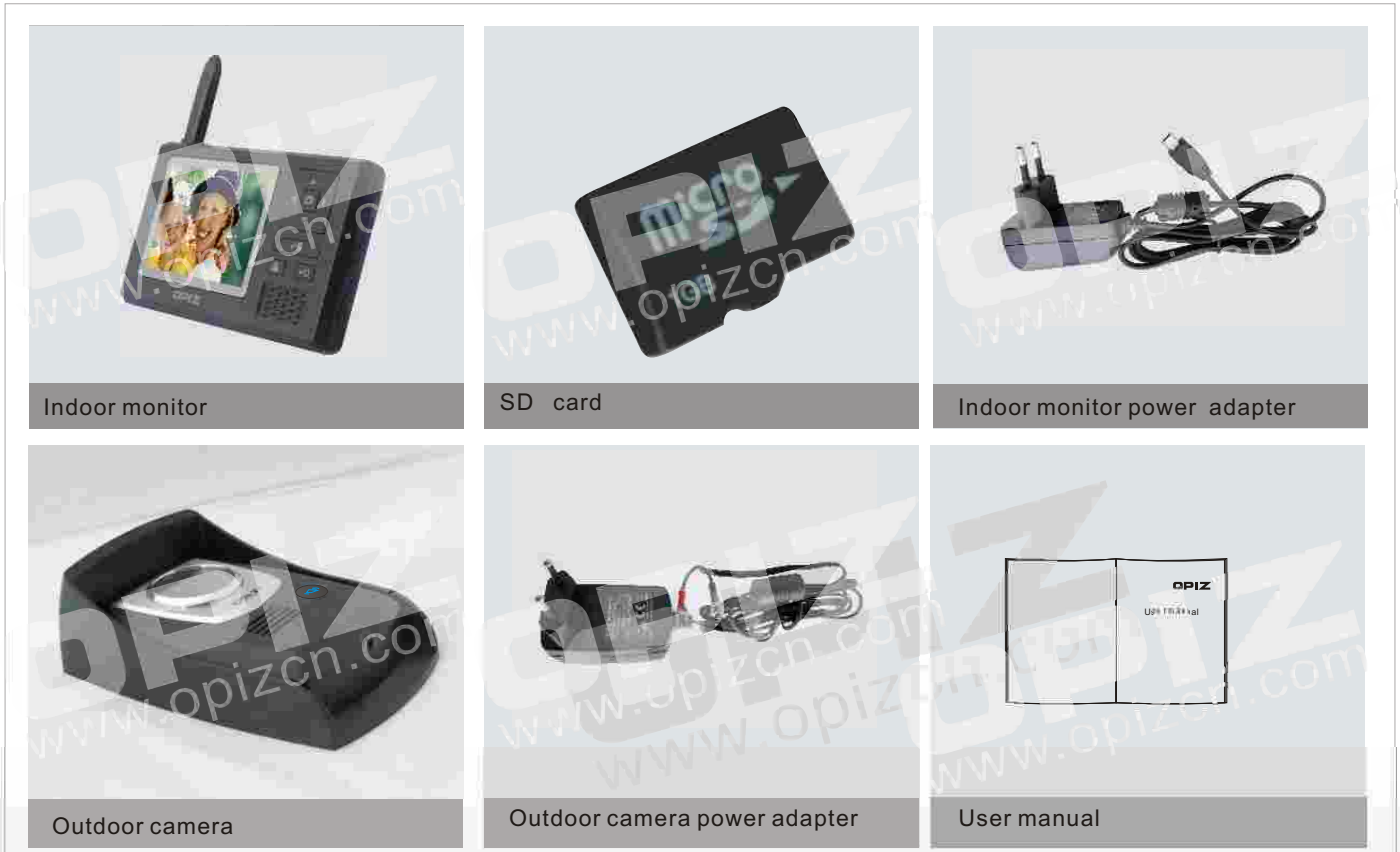

ENVIRONMENT

