

OWNERS MANUAL OF HSD006 RF SMOKE DETECTOR

Keystone's HSD006 Radio Photoelectric Smoke Detector will work with any one of Keystone's multi-channel receivers HRX005, HRX006, and HRX006A or the K600RF Wireless Control Panel.

INSTALLATION OR MOUNTING INFORMATION

Your smoke alarm is designed for easy mounting on a wall or ceiling. First, find a location for the HSD006 according to the instructions for recommended location below. It is strongly suggested that before holes are drilled in a ceiling or wall, you learn the transmitter code to the receiver and check that the radio signal can reach the receiver. Re-locate either the HSD006 or the receiver if range problems arise and try again.

Disconnect the smoke detector from the mounting bracket via the 3 way mini connector adjacent to the red jumper and insert three 1.5V batteries into the battery compartment in the mounting bracket, respecting the correct polarity. The transmitter portion of the HSD006 is contained in the mounting bracket. This transmitter comes randomly pre-coded from the factory with one of more than 59,000 different codes. To match this code with either the HRX006A or the K600RF Control Panel, code the transmitter as follows:

- The Receiver has a 'self-learn' function. Power up the receiver and press the 'self-learn' button on the receiver pcb.
- With the HSD006 transmitter at least one metre away from the receiver, press the test button located on the edge of the mounting bracket. The red LED will illuminate and a transmission will automatically be sent to the receiver.
- The code has now been learnt to the receiver.
- For further details, consult the receiver manual

The HSD006 is a 6-channel device. It comes preset to transmit on Channel 1. Set the 3 way dipswitch in the mounting bracket to transmit on the following channels. Refer to the receiver manual for information as to which receiver output wire corresponds to which channel:

- Channel 1 = Dipswitch 1 set to ON, Dipswitches 2 and 3 set to OFF
- Channel 2 = Dipswitch 2 set to ON, Dipswitches 1 and 3 set to OFF
- Channel 3 = Dipswitch 3 set to ON, Dipswitches 1 and 2 set to OFF
- Channel 4 = Dedicated Low Battery Channel (see below)
- Channel 5 = All three dipswitches set to OFF
- Channel 6 = Dipswitch 1 set to OFF, Dipswitches 2 and 3 set to ON

TRANSMITTER LOW BATTERY SIGNAL – The HSD006 can send a low battery signal to the receiver when the transmitter's batteries are low. Note that this low battery signal only applies to the transmitter batteries. A separate 9V battery powers the Smoke Detector portion and the Smoke Detectors built-in sounder will start to beep if this 9V battery goes low.

The red jumper selects whether the transmitter low battery feature is enabled or disabled. If the jumper is set to ON, it means that a transmitter low battery signal will be sent on Channel 4 together with the channel that the transmitter has been set to. Since the transmitter batteries should usually

last longer than the sensor battery, it may be preferable to set the jumper to OFF, so as to avoid false alarms, and change the transmitter batteries over as a matter of course each time the sensor battery is changed.

Once the transmitter has been correctly coded to the receiver and range tested, you need to complete the mounting procedure. Place the mounting bracket on the wall or ceiling. Use a pencil to mark two drill-holes on the wall or ceiling. Check the size of the screws provided and use a drill to drill the two holes on the wall or ceiling, then attach the mounting bracket on the wall or ceiling with the screws provided.

Now, install the Smoke Detector's 9V battery, then twist and lock the smoke alarm on the mounting bracket. Note that the smoke detector is equipped with a safety feature which prevents insertion of the mounting bracket unless a battery is already correctly installed. If your smoke alarm will not lock into the mounting bracket, check to make sure a battery is correctly installed.

After completion, check the solid (durable/ reliable) mounting of your smoke alarm. Otherwise improve it if necessary.

RECOMMENDED LOCATION OF THE HSD006 SMOKE DETECTOR

- * Locate the first smoke alarm in the immediate area of the bedrooms. Try to protect the exit path as the bedrooms are usually farthest from an exit. If more than one sleeping area exists, locate additional smoke alarms in each sleeping area.
- * Locate additional smoke alarms to protect any stairway as stairways act like chimneys for smoke and heat.
- * Locate at least one smoke alarm on every floor level.
- * Locate a smoke alarm in any area where a smoker sleeps or where electrical appliances are operated in sleeping areas.
- * Smoke, heat and other combustion products rise to the ceiling and spread horizontally. Mounting the smoke alarm in the ceiling in the center of the room places it closest to all points in the room. Ceiling mounting is preferred in ordinary residential construction. However, in mobile homes, wall mounting on an inside partition is preferred to avoid the thermal barrier that may form at the ceiling.
- * When mounting smoke alarm on the ceiling, locate it a minimum of 10cm (4 inches) from a side wall and 0.61 metres (2 feet) from any inside corner (see Diagram A).

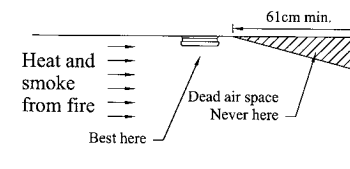
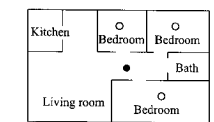

DIAGRAM A

Typical SINGLE floor installation



● Smoke alarm for minimum protection
○ Recommended smoke alarm for additional protection

Typical MULTIPLE floor installation

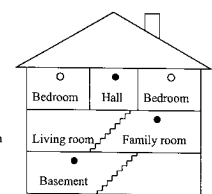

DO NOT LOCATE YOUR SMOKE ALARM IN:

- * the kitchen - smoke from cooking might cause an unwanted alarm.
- * the garage - products of combustion are present when you start your automobile.
- * in front of forced air ducts used for heating and air conditioning.
- * in the peak of an 'A' frame type of ceiling.
- * in areas where temperatures may fall below 5°C or rise above 45°C
- * do not mount a smoke alarm on the ceiling in a caravan or similar rooms. The shining sun heats the ceiling and the air at the upper part of the room. Hot air at the ceiling prevents the smoke from a dangerous smoulder process reaching the smoke detector.

THIS SMOKE ALARM WILL NOT OPERATE WITHOUT A BATTERY INSTALLED. PROPER BATTERY MUST BE INSTALLED IMMEDIATELY WHEN LOW BATTERY SIGNAL IS GIVEN OR THE UNIT WILL FAIL. TEST WEEKLY. READ AND FOLLOW ALL INSTRUCTIONS OR UNIT WILL NOT OPERATE PROPERLY.

DEVELOP AND PRACTICE A PLAN OF ESCAPE

BASICS OF ESCAPE PLAN

- * Make a floor plan indicating all doors and windows and at least two escape routes from each room. Second storey windows may need a rope or chain ladder.
- * Have a family meeting and discuss your escape plan, showing everyone what to do in case of fire.
- * Determine a place outside your home where all of you can meet if a fire occurs.
- * Familiarize everyone with the sound of the smoke alarm and train them to leave your home when they hear the sound.
- * Identify children's bedrooms with red stickers placed in the upper left corner of the windows for easy identification.
- * Practice a fire drill at least every six months. Practice allows you to test your plan before an emergency. You may not be able to reach your children. It is important they know what to do.

WHAT TO DO WHEN THE ALARM SOUNDS

- * Leave immediately by your plan of escape. Every second counts, so don't waste time getting dressed or picking up valuables.
- * In leaving, don't open any inside door without first feeling its surface. If hot, or if you see smoke seeping through cracks, don't open that door! Instead, use your alternate exit. If inside door is cool, place your shoulder against it, open it slightly and be ready to slam it shut if heat and smoke rush in.
- * Stay close to the floor if air is smoky. Breathe shallowly through a cloth, wet if possible.
- * Once outside, go to your selected meeting place and make sure everyone is there.
- * Call the fire department from your neighbour's home - not from yours.
- * Don't return to your home until fire officials say that it is all right to do so.

FALSE ALARMS

The smoke alarm is designed to minimize false alarms. Smoking will not normally set off the alarm unless smoke is blown directly into the smoke alarm. Combustion particles from cooking may set

off the alarm if the smoke alarm is located close to the kitchen cooking surface. Large quantities of combustion particles are generated from spills or grilling/frying.

Whenever the alarm is activated it should always be assumed that this is due to a fire and the building should be evacuated immediately.

If the smoke alarm does sound, check for fires first. If a fire is discovered, get out and call the fire department. If no fire is present, check to see if one of the reasons listed above may have caused the alarm.

OPERATION, TESTING & MAINTENANCE

OPERATION: The smoke alarm is operating once the power is connected and turned on (the battery must also be installed). When products of combustion are sensed, the unit sounds a loud alarm which continues until the air is cleared.

TESTING: Test by pushing the test button on the smoke alarm cover for at least four seconds, until the alarm sounds. It activates the self-test program and the built-in alarm sounds if all electronic circuitry, horn and battery are working. **If the transmitter portion is connected, this will also cause a test transmission to the radio receiver.** PLEASE DISPOSE OF THE BAD OR DISCHARGED BATTERIES PROPERLY TO PROTECT OUR ENVIRONMENT.

MAINTENANCE: The smoke alarm is virtually maintenance free. However, under dusty conditions, a vacuum hose may be used to clear the sensing chamber of dust.

BATTERY REPLACEMENT

The smoke alarm is powered by one 9VDC battery. The battery should last for at least one year under normal operating conditions. The smoke alarm has a low battery indicator, and audible 'chirp'. It will operate at 30 - 40 second intervals for a minimum of 7 days. Replace the battery when this indication occurs. Only following 9VDC batteries (available at most drug, hardware or electronic parts stores) may be used for replacement.

Carbon-Zinc Type: Eveready #216; Gold Peak #1604P (UL); Gold Peak #1604S; Gold Peak #1604G; Golden Power #G6F22; Golden Power #G6F22M; Golden Power #GE6F22; Hi-Watt #6F22MA; Hi-Watt #H6F22MX; Hi-Watt #E6F22MX.

Alkaline Type: Eveready Energizer #522; Gold Peak #1604A; Golden Power #GL6F22A; Hi-Watt #6LR61X; Duracell #MN1604.

Lithium Type: Ultralife #U9VL.

BATTERY DISPOSAL! Watch the national regulations for discarding of used batteries. It is recommended to use batteries marked '0% Mercury'.

The smoke alarm is designed to indicate if the battery has not been installed. The smoke alarm unit will not be able to be mounted on the wall mount bracket firmly without a battery inside the compartment. With a battery properly installed, the smoke alarm can be twisted and attached to the wall mount bracket easily.